

Spare parts for SMC 104-106-108 & TSMC 108 Mk3 Type S-L and E

Relevant drawings for compressor	SMC	TSMC
SMC 100 Mk 3, S-L-E (delivered after 89.10)	0661-521	0661-522
Cylinder liner ect. SMC - TSMC 104, 106, 108 Mk 3 (after 89.10)	0661-520	
SMC 100 Mk 3	0661-755	0661-756
Cylinder liner ect. SMC - TSMC 100 Mk3	0661-605	

*) If the compressor runs as heat pump, this must be mentioned when ordering, to ensure a correct delivery

Pos.	Designation	Weight each in kg	Number each compressor				Part no.
			SMC 104	SMC 106	SMC 108	TSMC 108	
	Compressor frame						
1A-1	Frame SMC 104	240.000	1				3111-065
1A-2	Frame SMC 106	274.000		1			3111-066
1A-3	Frame SMC 108	285.000			1		3111-067
1A-4	Frame TSMC 108	290.000				1	3111-068
1B-1	Oil level glass dia. 80	0.230	1	1	1	1	1226-015
1C-1	O-ring PRP 137 - 52,07 x 2,62 *)	0.002	1	1	1	1	1331-140
1D-1	Hexagon head M6 x 18	0.010	4	4	4	4	1424-148
	Top cover - air cooled						
2A-1	Top cover S-L	19.000	1	2	3	2	3113-191
2A-2	Top cover with flange S-L	20.500	1	1	1	2	3113-192
2A-3	Top cover E	19.000	1	2	3	2	3113-177
2A-4	Top cover with flange E	20.500	1	1	1	2	3113-176
2C-1	Gasket for top cover	0.020	2	3	4	4	2353-151
2E-1	Hexagon head M14 x 90	0.120	30	46	62	60	1424-083
2F-1	Hexagon head M14 x 120	0.165	2	2	2	4	1424-090
2G-1	Washer for M14 dia. 28/15 x 2,5	0.010	32	48	64	64	1436-076

WATER COVERS

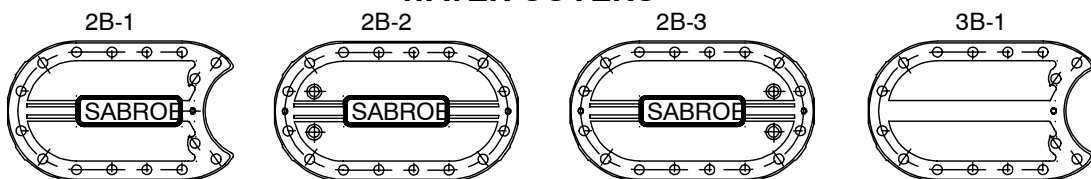

T0177125

Pos.	Designation	Weight each in kg	Number each compressor				Part no.
			SMC 104	SMC 106	SMC 108	TSMC 108	
	Top cover - water cooled (see sketch below)						
2A-1	Top covers S-L	19.000	1	2	3	2	3113-191
2A-2	Top cover with flange S-L	20.500	1	1	1	2	3113-192
2A-3	Top cover E	19.000	1	2	3	2	3113-177
2A-4	Top cover with flange E	20.500	1	1	1	2	3113-176
2B-1	Water cover for cover with flange	5.800	1	1	1	2	3113-195
2B-2	Water cover left	5.800	1	1	2	2	3113-193
2B-3	Water cover right	5.800		1	1		3113-194
2C-1	Gasket for top cover	0.020	2	3	4	4	2353-151
2D-1	Gasket for water cover pos. 2B-1	0.020	1	1	1	2	2353-176
2D-2	Gasket for water cover pos. 2B-2/2B-3	0.020	1	2	3	2	2353-175
2E-2	Hexagon head screw M14 x 110	0.150	30	46	62	60	1424-087
2F-1	Hexagon head screw M14 x 120	0.165	2	2	2	4	1424-090
2G-1	Washer for M14, dia. 28/15 x 2,5	0.010	32	48	64	64	1436-076
2H-1	Hexagon head screw M10 x 35	0.050	4	6	8	8	1424-193
2J-1	Washer for M10, dia. 21/10,5 x 2	0.008	4	6	8	8	1436-035
	Side cover - air cooled						
3A-1	Side cover	10.900	2	2	2	2	3113-148
3C-1	Gasket for side cover	0.020	2	2	2	2	2353-151
3E-1	Hexagon head screw M14 x 65	0.045	32	32	32	32	1424-246
3G-1	Washer for M14, dia. 28/15 x 2,5	0.010	32	32	32	32	1436-076
	Side cover - water cooled						
3A-2	Side cover	15.000	2	2	2	2	3113-140
3B-1	Water cover	5.800	2	2	2	2	3113-138
3C-1	Gasket for side cover	0.020	2	2	2	2	2353-151
3D-1	Gasket for water cover	0.020	2	2	2	2	2353-154
3E-2	Hexagon head screw M14 x 55	0.065	28	28	28	28	1424-244
3F-1	Hexagon head screw M14 x 35	0.045	4	4	4	4	1424-240
3G-1	Washer for M14, dia. 28/15 x 2,5	0.010	32	32	32	32	1436-076
3H-1	Hexagon head screw M12 x 40	0.050	2	2	2	2	1424-217
3J-1	Washer for M12, dia. 24/13 x 2,5	0.008	2	2	2	2	1436-036
	End cover at pump end						
4A-1	End cover	17.950	1	1	1	1	3113-028
4B-1	Gasket	0.020	1	1	1	1	2353-011
4C-1	Hexagon head screw M14 x 100	0.150	14	14	14	14	1424-085
4D-1	Washer for M14 dia. 28/15 x 2,5	0.010	14	14	14	14	1436-076
	Bearing cover at pump end						
5A-1	Bearing cover	9.100	1	1	1	1	3113-031
5B-1	Hexagon head screw M14 x 35	0.055	6	6	6	6	1424-240
5C-1	Bushing	1.200	1	1	1	1	2132-021
5C-2	Bushing for repair (0,5 mm undersize)	1.220	1	1	1	1	2132-022

Pos.	Designation	Weight each in kg	Number each compressor				Part no.
			SMC 104	SMC 106	SMC 108	TSMC 108	
5D-11	Gasket - 0,3 mm	0.005	1	1	1	1	2353-013
5D-2	Gasket - 0,5 mm	0.006	1	1	1	1	2353-100
5D-3	Gasket - 0,75 mm	0.010	1	1	1	1	2353-014
5D-4	Gasket - 1,0 mm	0.015	1	1	1	1	2353-015
	Bearing cover at shaft seal end						
6A-1	Bearing cover	23.000	1	1	1	1	3113-124
6B-1	Hexagon head screw M14 x 60	0.085	14	14	14	14	1424-245
6C-3	Bushing	1.200	1	1	1	1	2132-021
6C-4	Bushing for repair (0,5 mm undersize)	1.200	1	1	1	1	2132-022
6D-1	Gasket	0.020	1	1	1	1	2353-011
6E-1	Washer for M14, dia. 28/15 x 2,5	0.010	14	14	14	14	1436-076
6F	Valve for prelubrication		1	1	1	1	2412-585
6G	Nut		1	1	1	1	2313-045
6H	Special joint		1	1	1	1	2334-027
6J	Cap		1	1	1	1	2313-027
6K	Joint 3/8"		1	1	1	1	1349-053
6L	Alu gasket		1	1	1	1	2356-123
	Shaft seal type SB100 <i>Revision 1 for compressor nos. up to 98379</i>						
	Spare parts kit:		1	1	1	1	3184-225
	Consist of: - see <i>Revision 3</i>						
	Revision 2 for compressor nos. after 98379 incl.						
	Spare parts kit:		1	1	1	1	3126-178
	Consist of:		1	1	1	1	
10E-2	Slide ring, steel						
10F-1	Slide ring, carbon		1	1	1	1	
10D-1	O-ring dia. 75,79 x 3,53		1	1	1	1	
10G-2	Sealing ring		1	1	1	1	
10J-1	Hex. socket screw M5 x 16		4	4	4	4	
13	Allen key - NV 4 x 90 x 90		1	1	1	1	
8B-1	Gasket for cover		1	1	1	1	
	<i>Mounting instruction</i>						0171-934
	Revision 3						
	Spare parts kit:		1	1	1	1	3184-225
	Consist of:						
10E-1	Slide ring, steel		1	1	1	1	
10F-1	Slide ring, carbon		1	1	1	1	
10D-1	O-ring dia. 75,79 x 3,53		1	1	1	1	
10G-1	O-ring dia. 82,14 x 3,53		1	1	1	1	
10J-1	Hex. socket screw M5 x 16		4	4	4	4	

Pos.	Designation	Weight each in kg	Number each compressor				Part no.
			SMC 104	SMC 106	SMC 108	TSMC 108	
13	Allen key - NV 4 x 90 x 90		1	1	1	1	
8B-1	Gasket for cover <i>Mounting instruction</i>		1	1	1	1	0171-930
	Shaft seal complete: SMC/TSMC 100 <i>Consist of:</i>		1	1	1	1	3184-226
8A-2	Cover (SMC/TSMC 100)		1	1	1	1	3113-175
8B-1	Gasket for cover		1	1	1	1	2353-005
8C-1	Hex. head screw M10 x 40 - DIN 933		6	6	6	6	1424-194
	Allen key - NV 4 x 90 x 90		1	1	1	1	1612-392
8D-1	Hose connection 1/4"		1	1	1	1	1345-143
8E-1	PVC hose 3/16" x 400						1241-190
8F-1	Spirolox ring dia. 76		1	1	1	1	1437-295
8G-1	Lock spring		1	1	1	1	3126-169
8H-1	Groover pin dia. 4 x 20		1	1	1	1	1446-081
10A-1	Retaining flange		1	1	1	1	3126-166
10B-1	Spring		10	10	10	10	2142-058
10D-1	O-ring dia. 75,79 x 3,53		1	1	1	1	1331-075
10E-2	Slide ring, steel		1	1	1	1	3126-167
10F-1	Slide ring, carbon		1	1	1	1	3126-168
10G-1	O-ring dia. 82,14 x 3,53		1	1	1	1	1331-077
10H-1	Locking ring		1	1	1	1	3126-153
10J-1	Hex. socket screw M5 x 16		4	4	4	4	1413-329
11-1	Oil pump Oil pump complete <i>Contains:</i> - Oil pump 11J - Lock nut, M10 x 10,7 11L- Washer for M10 dia. 21/10,5 x 2 11N - Key 5 x 5 x 12 11P - Gasket dia. 32/27 x 1,5 11S - Threaded nipple	2.400	1	1	1	1	3141-004
11G-1	Gear whell for pump pinion	0.660	1	1	1	1	3141-046
11H-1	Gear wheel for crank shaft	0.530	1	1	1	1	3141-047
11M-1	Hexagon head screw M6 x 25	0.010	4	4	4	4	1424-153
11Q-1	Hexagon head screw M12 x 30	0.040	2	2	2	2	1424-215
11R-1	Spring washer dia. 12	0.002	2	2	2	2	1437-081
11T-1	Spring washer - dia. 11,1/6,1 x 1,6	0.005	4	4	4	4	1437-022

Pos.	Designation	Weight each in kg	Number each compressor				Part no.
			SMC 104	SMC 106	SMC 108	TSMC 108	
	Unloading cylinder						
12-1	Unloading cylinder Complete L=75, S=21,5	1.765	1	1	1		3135-149
12-2	Unloading cylinder Complete L=100, S=46,5	1.790	1	1	1	1	3135-150
12-3	Unloading cylinder Complete L=125, S=71,5	1.815		1	1	1	3135-151
12-4	Unloading cylinder Complete L=150, S=96,5	1.840			1	1	3135-152
12-5	Unloading cylinder (HP) Complete L=82, S=24,5	1.800				1	3135-161
12A-1	Unloading cylinder (SMC and TSMC LP)	1.700	2	3	4	3	3135-147
12A-2	Unloading cylinder (TSMC HP)	1.800				1	3135-148
12B-1	Piston	0.220	2	3	4	4	3135-034
12C-1	Piston rod 75 mm (SMC only)	0.065	1	1	1		3135-041
12C-2	Piston rod 100 mm	0.090	1	1	1	1	3135-042
12C-3	Piston rod 125 mm	0.115		1	1	1	3135-043
12C-4	Piston rod 150 mm	0.140			1	1	3135-044
12C-5	Piston rod 82 mm, grounded (TSMC HP only)	0.090				1	3135-140
12D-1	Threaded plug - 3/8" BSP	0.065	2	3	4	4	2314-025
12E-1	Gasket - dia. 25/17 x 1,5	0.002	2	3	4	4	2356-130
12F-1	Seeger ring dia. 52 (SMC and TSMC LP)	0.008	2	3	4	3	1437-155
12G-1	Spring guide	0.040	2	3	4	4	2145-004
12H-1	Spring retainer (SMC and TSMC LP)	0.110	2	3	4	3	3135-057
12J-1	Spring (outer)	0.065	2	2	4	4	2142-056
12J-2	Spring (inner)	0.035	2	3	4	4	2142-055
12K-1	Benzing ring - dia. 9 mm	0.002	2	3	4	4	1437-105
12K-2	Benzing ring - dia. 7 mm (SMC and TSMC LP)	0.001	2	3	4	3	1437-103
12L-1	Hexagon head screw M10 x 30	0.030	8	12	16	16	1424-192
12M-1	Cover (TSMC HP only)	0.800				1	3135-105
12N-1	Gasket for cover (TSMC HP only)	0.010				1	2353-025
12P-1	Lock nut - UNF 3/8" (TSMC HP only)	0.010				1	1433-100
12Q-1	Socket cap screw M4 x 16 (TSMC HP only)	0.010				6	1413-007
12R-1	O-ring PRP 112 12,37 x 2,62 (TSMC HP only)*	0.001				1	1331-013
12S-1	Gasket 100 x 100 x 2	0.010	2	3	4	4	2354-023
	Frame for unloading mechanism						
	Frame complete incl. pos. 13E-1						3184-216
13A-1	Suspension rod	0.290	2	3	4	4	

Pos.	Designation	Weight each in kg	Number each compressor				Part no.
			SMC 104	SMC 106	SMC 108	TSMC 108	
13B-1	Suspension rod	0.290	2	3	4	4	
13C-1	Cross piece	0.330	2	3	4	4	
13D-1	Cross piece	0.330	2	3	4	4	
13E-1	Countersunk screw M6 x 16	0.020	8	12	16	16	1413-092
	Bracket for unloading mechanism						
14A-1	Bracket with pin	0.065	4	6	8	7	3135-060
14B-1	Spacing ring	0.005	8	12	16	14	2124-003
14C-1	Hexagon head screw M6 x 30	0.010	8	12	16	14	1424-154
14D-1	Spring washer - dia. 6	0.005	8	12	16	14	1437-022
	Rocker for unloading mechanism						
15A-1	Rocker	0.050	8	12	16	16	3135-096
15B-1	Bearing for SMC and TSMC LP	0.006	8	12	16	12	3135-099
15B-2	Bearing for TSMC HP	0.006				4	3135-101
15C-1	Spring retainer	0.001	8	12	16	16	2145-001
15D-1	Spring	0.007	8	12	16	16	2142-061
15E-1	Washer for bearing cup - 0,5 mm	0.001					2114-003
	Crankshaft - all without certificate						
16A-1	Crankshaft for SMC 104S, complete	42.400	1				3121-018
16A-2	Crankshaft for SMC 106S, complete	45.400		1			3121-019
16A-3	Crankshaft for SMC 108S and TSMC 108S, complete	47.600			1	1	3121-020
16A-4	Crankshaft for SMC 104L, complete	45.600	1				3121-104
16A-5	Crankshaft for SMC 106L, complete	47.800		1			3121-105
16A-6	Crankshaft for SMC 108L and TSMC 108L, complete	50.600			1	1	3121-106
16A-11	Crankshaft for SMC 104E, complete		1				3121-213
16A-12	Crankshaft for SMC 106E, complete			1			3121-214
16A-13	Crankshaft for SMC 108E and TSMC 108E, complete				1	1	3121-215
16B-1	Plain washer with pin	0.800	1	1	1	1	2125-084
16C-1	Key - 18 x 11 x 55	0.080	1	1	1	1	2123-005
16D-1	Hexagon head screw M16 x 55	0.050	1	1	1	1	1424-104
16E-1	Spring washer - dia. 16	0.004	1	1	1	1	1437-027
16F-1	Plug M12 S-type	0.010	1	1	1	1	1413-260
16F-2	Plug 1/4" L-type	0.010	3	3	3	3	1343-141
	Connecting rod						
17-1	Connecting rod, complete SMC and TSMC LP	2.700	4	6	8	6	3123-004
17-2	Connecting rod, complete TSMC HP	2.700				2	3123-006
17A-1	Half-section of bearing	0.080	8	12	16	16	2133-003
17A-2	Half-section of bearing (0,5 mm undersize)	0.080	8	12	16	16	2133-004

Pos.	Designation	Weight each in kg	Number each compressor				Part no.
			SMC 104	SMC 106	SMC 108	TSMC 108	
17B-1	Bushing for piston pin SMC and TSMC LP	0.200	4	6	8	6	2132-004
17B-2	Needle roller bearing TSMC HP	0.200				2	1511-275
17C-1	Bolt for connecting rod	0.055	8	12	16	16	2111-068
17D-1	Lock nut - 3/8" UNF	0.010	8	12	16	16	1433-116
	Piston with pin and rings						
18-1	Piston with pin and rings S	1.320	4	6	8	8	3124-002
18-2	Piston with pin and rings L	1.320	4	6	8	8	3124-052
18-3	Piston with pin and rings E	1.320	4	6	8	8	3124-065
18A-1	Piston pin	0.500	4	6	8	8	3125-084
18B-1	Piston ring	0.025	8	12	16	16	3125-130
18C-1	Oil scraper rings	0.030	4	6	8	8	3125-065
18D-1	Seeger-ring - dia. 40 (inside diameter)	0.005	8	12	16	16	1437-150

Pos.	Designation	Weight each in kg	Number each compressor				Part no.
			SMC 104	SMC 106	SMC 108	TSMC 108	
	Cylinder liner with suction valve						
19-1	Cylinder liner with suction valve R717, SMC - TSMC LP, S and L	4.100	4	6	8	6	3112-085
19-5	Cylinder liner with suction valve R717, SMC - TSMC LP, E	4.500	4	6	8	6	3112-081
19-2	Cylinder liner with suction valve HFC/HCFC, SMC - TSMC LP, S and L	4.100	4	6	8	6	3112-086
19-3	Cylinder liner with suction valve R717, SMC - TSMC HP, S and L	4.100				2	3112-087
19-6	Cylinder liner with suction valve R717, SMC - TSMC HP, E	4.500				2	3112-097
19-4	Cylinder liner with suction valve HFC/HCFC, TSMC HP, S and L	4.100				2	3112-088
19A-1	Cylinder liner S and L	3.500	4	6	8	8	3112-065
19A-2	Cylinder liner, E	4.000	4	6	8	8	3112-080
19B-1	Unloading rings with pins, S and L	0.400	4	6	8	8	3135-054
19B-2	Unloading rings with pins, E	0.500	4	6	8	8	3135-173
19C-1	Washer - dia. 8/4,3 x 0,5	0.001	24	36	48	48	2114-001
19D-1	Spring for unloading ring	0.001	24	36	48	48	2142-034
19E-1	Tension spring - 342 mm	0.015	4	6	8	8	2142-048
19F-1	Ring plate for suction valve	0.035	4	6	8	8	3131-021
19G-1	Valve spring	0.001	24	36	48	48	2141-047
19H-1	Suction valve retaining plate R717	1.400	4	6	8	8	3132-083
19H-2	Suction valve retaining plate R12/R22	1.400	4	6	8	8	3132-084
19J-1	Guide ring for discharge valve	0.450	4	6	8	8	3134-008
19K-1	Gasket for cylinder liner - 0,5 mm	0.005	4	6	8	8	2356-111
19K-2	Gasket for cylinder liner - 0,8 mm	0.006	4	6	8	8	2356-233
19M-1	O-ring 107,55 x 3,53*) TSMC HP	0.002				2	1331-085
19N-1	Socket cap screw M6 x 30	0.010	24	36	48	48	1413-343
19T-1	Gasket - dia. 163/141 x 0,2 mm	0.001	4	6	8	8	2353-140

Pos.	Designation	Weight each in kg	Number each compressor				Part no.
			SMC 104	SMC 106	SMC 108	TSMC 108	
	Discharge valve**)						
20-1	Disharge valve - R717 - HP	1.200	4	6	8	2	3136-089
20-2	Disharge valve - R717 - LP	1.200	4	6	8	6	3136-087
20-3	Disharge valve - HFC/HCFC - HP	1.200	4	6	8	2	3136-088
20-4	Disharge valve - HFC/HCFC - LP	1.200	4	6	8	6	3136-086
20-5	Disharge valve - HFC/HCFC - VHP	1.200	4	6	8		3136-085
20A-1	Disharge valve seat	0.250	4	6	8	8	3133-027
20B-1	Retaining plate - R717 - HP	1.000	4	6	8	2	3132-092
20B-2	Retaining plate - R717 - LP	1.000	4	6	8	6	3132-090
20B-3	Retaining plate - HFC/HCFC - HP	1.000	4	6	8	2	3132-093
20B-4	Retaining plate - HFC/HCFC - LP	1.000	4	6	8	6	3132-091
20B-5	Retaining plate - HFC/HCFC - VHP	1.000	4	6	8	-	3132-094
20C-1	Ring plate	0.030	4	6	8	8	3131-015
20D-1	Special screw M12 x 60	0.055	4	6	8	8	1413-121
20E-1	Nut M12 x 1,25	0.015	8	12	16	16	1432-075
20F-1	Spring guide	0.015	4	6	8	8	2145-008
20G-1	Valve spring - R717 - HP	0.001	32	48	64	16	2141-047
20G-1	Valve spring - R717 - LP	0.001	24	36	48	36	2141-047
20G-1	Valve spring - HFC/HCFC - HP	0.001	48	72	96	24	2141-047
20G-1	Valve spring - HFC/HCFC - LP	0.001	24	36	48	36	2141-047
20G-1	Valve spring - HFC/HCFC - VHP	0.001	64	96	128		2141-047

***) Compressors are fitted with discharge valves depending on the working conditions. The valve is selected on the basis of the refrigerant and the condensing/intermediate pressure temperature of the plant, indicated in the table in °C. For inst. R22 at TC=53°C=>VHP discharge valve.

Refrigerant	Conditions	Valve type
R717	TC < 15°C	LP
	TC ≥ 15°C	HP
HFC/ HCFC	TC < 15°C	LP
	15°C ≤ TC < 45°C R404A-R507 50°C R22 70°C R134a	HP
	TC ≥ 45°C R404A-R507 50°C R22 70°C R134a	VHP

Pos.	Designation	Weight each in kg	Number each compressor				Part no.
			SMC 104	SMC 106	SMC 108	TSMC 108	
21-1	Spring for safety head Spring	0.400	4	6	8	8	2142-060
22A-1	Oil pressure valve Oil pressure valve, complete	0.450	1	1	1	1	3142-150
22B-1	Gasket 90 x 44 x 1	0.001	1	1	1	1	2354-075
22C-1	Hexagon head screw M12 x 35	0.040	2	2	2	2	1424-216
23A-1	Oil charging valve Oil charging valve, complete	0.300	1	1	1	1	2412-585
23B-1	Threaded reducing nipple	0.155	1	1	1	1	2311-059
23C-1	Socket	0.075	1	1	1	1	2313-035
23D-1	Gasket	0.001	1	1	1	1	2356-123
23E-1	Gasket	0.001	1	1	1	1	2356-140
23F-1	Gasket	0.001	1	1	1	1	2356-283
23G-1	Nut	0.060	1	1	1	1	2313-027
24-1	By-pass valves By-pass valve dia. 20 TSMC 108 HP	22 bar 2.400				1	3137-033
24-2	By-pass valve dia. 20 TSMC 108 HP	24 bar 2.400				1	3137-010
24-4	By-pass valve dia. 28 TSMC 108 LP	14 bar 3.600				1	3137-046
24-5	By-pass valve dia. 28 SMC	22 bar 3.600	1	1	1		3137-007
24-7	By-pass valve dia. 28 SMC	24 bar 3.600	1	1	1		3137-009
24B-1	O-ring for cylinder *)	0.001				1	1331-065
24B-4	O-ring for cylinder *)	0.002	1	1	1	1	1331-067
24C-1	O-ring for cover *)	0.002				1	1331-069
24C-4	O-ring for cover *)	0.003	1	1	1	1	1331-071
24D-1	Hexagon head screw M8 x 25	0.015	4	4	4	8	1424-168
24E-1	Spring washer dia. 14,2/8,2 x 2	0.002	4	4	4	8	1437-023

Pos.	Designation	Weight each in kg	Valve dim.	Number each compressor				Part no.
				SMC 104	SMC 106	SMC 108	TSMC 108	
	Stop valves							
25-1	Complete valve, discharge HP		50				1	2414-073
25-2	Complete valve, inlet HP		50				1	2411-261
25-3	Complete valve, discharge LP		65	1	1	1	1	2414-069
25-4	Complete valve, inlet LP		100	1	1	1	1	2414-070
25A-1	Valve housing		50				1	2432-141
25A-2	Valve housing		50				1	2432-141
25A-3	Valve housing		65	1	1	1	1	2432-159
25A-4	Valve housing		100	1	1	1	1	2432-160
25B-1	Valve bonnet	1.740	50-65	1	1	1	3	2433-028
25B-4	Valve bonnet	4.500	100	1	1	1	1	2433-030
25C-1	Front part for cone	0.095	50-65	1	1	1	3	2444-090
25C-3	Front part for cone	0.520	100	1	1	1	1	2444-094
25D-1	Rear part for cone	0.185	50-65	1	1	1	3	2444-091
25D-4	Rear part for cone	1.000	100	1	1	1	1	2444-095
25E-1	Screw for valve cone	0.020	50-65	1	1	1	3	2444-017
25E-4	Screw for valve cone	0.120	100	1	1	1	1	2444-018
25F-1	Gasket for screw dia. 31/24 x 1,5	0.0001	50-65	1	1	1	3	2356-138
25F-4	Gasket for screw dia. 36/28 x 1,5	0.001	100	1	1	1	1	2356-141
25G-1	Threaded connection	0.180	50-65	1	1	1	3	2445-053
25G-4	Threaded connection	0.400	100	1	1	1	1	2445-061
25H-1	Sealing ring dia. 62/45 x 3	0.004	50-65	1	1	1	3	2354-003
25H-4	Sealing ring dia. 110/90 x 3	0.020	100	1	1	1	1	2354-117
25J-1	Gasket for bonnet dia. 72,39 x 5,33	0.010	50-65	1	1	1	3	1331-154
25J-4	Gasket for bonnet dia. 116,84 x 7	0.015	100	1	1	1	1	1331-198
25K-1	Spindle	0.250	50-65	1	1	1	3	2442-023
25K-4	Spindle	0.480	100	1	1	1	1	2442-028
25L-1	Lock washer for spindle	0.010	50-65	1	1	1	3	2445-019
25L-4	Lock washer for spindle	0.015	100	1	1	1	1	2445-020
25M-1	Packing gland Compl. with o-rings pos. 25R-1	0.120	50-65	1	1	1	3	2452-073
25M-4	Packing gland Compl. with o-rings pos. 25R-4	0.250	100	1	1	1	1	2452-004
25N-1	Guide pin	0.002	50-65	1	1	1	3	1445-085
25N-4	Guide pin	0.002	100	1	1	1	1	1445-085
25P-1	O-ring dia. 21,8 x 3,5*)	0.002	50-65	1	1	1	3	1331-020
25P-4	O-ring dia. 28,2 x 3,5*)	0.002	100	1	1	1	1	1331-024
25Q-1	Nylon washer dia. 28,5/28 x 1,5	0.001	50-65	1	1	1	3	2354-018
25Q-4	Nylon washer dia. 48/34 x 1,5	0.002	100	1	1	1	1	2354-017

Pos.	Designation	Weight each in kg	Valve dim.	Number each compressor				Part no.
				SMC 104	SMC 106	SMC 108	TSMC 108	
25R-1	O-ring dia. 17,12 x 3,5*)	0.001	50-65	2	2	2	2	1331-016
25R-4	O-ring dia. 21,8 x 3,5	0.002	100	2	2	2	2	1331-020
25S-1	Hand wheel dia. 120	0.160	50-65	1	1	1	3	1365-036
25S-4	Hand wheel dia. 180	0.800	100	1	1	1	1	1365-035
25T-1	Screw for hand wheel M5 x 10	0.002	50-65	1	1	1	3	1424-140
25T-4	Screw for hand wheel M8 x 16	0.010	100	1	1	1	1	1424-166
25U-1	Washer for hand wheel	0.001	50-65	1	1	1	3	1436-024
25U-4	Washer for hand wheel	0.003	100	1	1	1	1	1436-026
25Y-3	Gasket for welding nipple	0.015	50-65	1	1	1	1	2356-087
25Y-4	Gasket for welding nipple	0.025	100	1	1	1	1	2356-104
25Z-1	Screw valve/compr. M14 x 40	0.050	50	4	4	4	4	1424-241
25Z-3	Screw valve/compr. M14 x 45	0.050	65	4	4	4	4	1424-242
25Z-4	Screw valve/compr. M16 x 45	0.095	100	4	4	4	4	1424-102
25AC-3	Counter flange		65	1	1	1	1	2344-019
25AC-4	Counter flange		100	1	1	1	1	2344-020
25AD-3	Welding nipple dia. 65		65	1	1	1	1	2322-103
25AD-4	Welding nipple dia. 100		100	1	1	1	1	2322-108
25AF-3	Threaded plug 3/4" BSP		65	1	1	1	1	2314-065
25AF-4	Threaded plug 3/4" BSP		100	1	1	1	1	2314-065
25AG-1	Gasket for valve/compr.	0.016	50				1	2354-105
25AG-3	Gasket for valve/compr.	0.016	65	1	1	1	1	2354-105
25AG-4	Gasket for valve/compr.	0.020	100	1	1	1	1	2354-106
25AH-3	Gasket for plug	0.002	65	1	1	1	1	2356-139
25AH-4	Gasket for plug	0.002	100	1	1	1	1	2356-139
25AJ-1	Screw bonnet/valve M10 x 25		50				8	1424-191
25AJ-2	Screw bonnet/valve M10 x 25		50				8	1424-191
25AJ-3	Screw bonnet/valve M10 x 25		65	8	8	8	8	1424-191
25AJ-4	Screw bonnet/valve M12 x 30	0.040	100	8	8	8	8	1424-215
25AK-3	Screw for counter flange M10 x 40	0.030	65	6	6	6	6	1424-194
25AK-4	Screw for counter flange M12 x 50	0.050	100	6	6	6	6	1424-219

Pos.	Designation	Weight each in kg	Number each compressor				Part no.
			SMC 104	SMC 106	SMC 108	TSMC 108	
	Pressure gauges						
	Suction and pressure gauge						
30A-1	R717	1.640	1	1	1	1	1541-108
30A-2	R12, R22 and R502	1.620	1	1	1	1	1541-232
30A-3	R22, R134a and R404A	1.620	1	1	1	1	1541-074
30B-1	Nozzle and gasket dia. 14/0,8 x 1,5	0.001	1	1	1	1	3146-013
30C-1	Gasket dia. 11/4 x 1,5	0.001	1	1	1	1	2356-119
	SMC: discharge pressure gauge						
31A-1	R717	1.380	1	1	1		1541-029
31A-2	R12, R22 and R502	1.400	1	1	1		1541-160
31A-3	R22, R134a and R404A	1.400	1	1	1		1541-075
31B-1	Nozzle and gasket dia. 14/0,8 x 1,5	0.001	1	1	1		3146-013
	TSMC: discharge pressure gauge						
31A-3	R717	1.600				1	1541-101
31A-4	R12, R22 and R502	1.660				1	1541-161
31A-5	R22, R134a and R404A	1.660				1	1541-076
31B-1	Nozzle and gasket dia. 14/0,8 x 1,5	0.001				2	3146-013
31C-1	Screws for gauges M4 x 20		6	6	6	6	1412-350
	Oil filter						
33-1	Oil filter complete (33A,33B.33L,33M)		1	1	1	1	3084-539
33A-1	Filter element		1	1	1	1	1517-129
33B-1	Gasket		1	1	1	1	2356-202
33F-1	Bracket with connection		1	1	1	1	3422-152
33L-1	Washer dia. 17/8,4		1	1	1	1	1436-034
33M-1	Nut M8		1	1	1	1	1433-073
33R-1	Cutting ring joint		1	1	1	1	1349-131
	Suction filter						
34A-1	Suction filter open, complete	0.365	2	2	2	1	3425-082
34A-2	Suction filter closed, complete	0.365				1	3425-084
34B-1	Filter bag	0.035	2	2	2	2	3425-083
34C-1	Inset for filter bag	0.025	2	2	2	2	3424-058
34D-1	O-ring PRP 337 - 75,56 x 5,33 *)	0.008	2	2	2	3	1331-042
34E-1	Cover for suction filter	2.400	2	2	2	1	3422-103
34F-1	O-ring PRP 239 - 91,67 x 3,53 *)	0.003	2	2	2	1	1331-080
34G-1	Hexagon head screw M12 x 40	0.050	8	8	8	4	1424-217
34H-1	Spring washer dia. 12	0.005	8	8	8	4	1437-026
	Discharge pipe for oil filter						
38A-1	Discharge pipe for oil pump	0.500	1	1	1	1	3141-110
38B-1	Inside pipe connection to control system (compr. without oil cooler)	0.090	1	1	1	1	3141-162

Pos.	Designation	Weight each in kg	Number each compressor				Part no.
			SMC 104	SMC 106	SMC 108	TSMC 108	
38B-2	Inside pipe connection to control system (compr. with OSS1 oil cooler R717)	0.090	1	1	1	1	3141-163
28B-3	Inside pipe connection to control system (compr. with HE8 oil cooler HCFC)	0.090	1	1	1	1	3141-164
38C-1	Connection for discharge pipe - SMC 104	0.120	1				2333-025
38C-2	Connection for discharge pipe - SMC 106	0.190		1			2333-025
38C-3	Connection for discharge pipe - SMC 108 and TSMC 108	0.180			1	1	2333-026
38D-1	O-ring PRP 212 - 21,80 x 3,53*)	0.002	2	2	2	2	1331-020
38E-1	O-ring PRP 321 - 29,51 x 5,33*)	0.004	1	1	1	1	1331-039
38F-1	Gasket dia. 27/21 x 1,5	0.001	1	1	1	1	2356-133
38G-1	O-ring dia. 26,58 x 3,5*)	0.002	1	1	1	1	1331-023
	Analogous control and safety equipment						
39A-1	Gauge panel	0.070	1	1	1	1	3146-042
39B-1	Socket cap screw M10 x 60	0.045	2	2	2	2	1413-382
39C-1	Console		1	1	1	1	2213-142
39D-1	Bar for controls (4 controls)		1	1	1		2213-143
39D-2	Bar for controls (5 controls)		1	1	1	1	2213-144
39D-3	Bar for controls (6 controls)		1	1	1	1	2213-145
39D-4	Bar for controls (7 controls)		1	1	1	1	2213-154
39D-5	Bar for controls (US, SMC)		1	1	1		2213-368
39D-6	Bar for controls (US, TSMC)					1	2213-369
39E-1	Hexagon head screw M6 x 12		2	2	2	2	1424-150
39F-1	Spring washer dia. 11/6		2	2	2	2	1437-022
39G-1	Socket cap screw M4 x 6						1412-200
39H-1	Spring washer dia. 7/4						1437-020
39J-1	Socket cap screw M5 x 10		4	4	4	4	1413-330
39K-1	Spring washer dia. 9/5		4	4	4	4	1437-021
	Cooling water connection See section: <i>Water cooling of reciprocating compressor</i>						
40A-1	Set of hoses for cooling water SMC 104		1				3185-230
40A-2	Set of hoses for cooling water SMC 106			1			3185-231
40A-3	Set of hoses for cooling water SMC 108 and TSMC 108				1	1	3185-232
40A-4	SMC 108 for SIDE COVER only						3185-235

Pos.	Designation	Weight each in kg	Number each compressor				Part no.
			SMC 104	SMC 106	SMC 108	TSMC 108	
	Purge valve						
42A-1	Purge valve	0.300	1	1	1	2	2412-585
42B-1	Threaded nipple		1	1	1	1	1349-078
42C-1	Cutting ring	0.135	1	1	1	2	1349-062
42D-1	Nut						
42E-1	Nut	0.070	1	1	1	2	2313-045
42F-1	Connection pipe with collar	0.025	1	1	1	2	2334-027
42G-1	Gasket	0.001	2	2	2	4	2356-123
42H-1	Nut	0.060	1	1	1	2	2313-027
	Pressure and temperature controls						
	Pressure controls for R717						
45A-1	KP 5A	0.300	1	1	1	1	1373-125
45B-1	KP 15A	0.460	1	1	1	1	1373-142
45C-1	MP 55A	0.900	1	1	1	1	1373-162
42F-1	Connection pipe with collar	0.025	1	1	1	1	2334-027
42G-1	Gasket	0.001	2	2	2	2	2356-123
42H-1	Nut	0.060	1	1	1	1	2313-027
	Pressure controls for R22, R134a and R404A						
45D-1	KP 5	0.300	1	1	1	1	1373-123
45E-1	KP 15	0.460	1	1	1	1	1373-135
45F-1	MP 55	0.800	1	1	1	1	1373-159
	Temperature controls:						
45G-1	KP 98	0.720	1	1	1	1	1373-043
45H-1	KP 77	0.350	1	1	1	1	1373-044
45J-1	Phail pocket for temperature controls	0.770	1	1	1	1	1377-171
45K-1	Gasket		1	1	1	1	2356-133

Pos.	Designation	Weight each in kg	Number each compressor				Part no.
			SMC 104	SMC 106	SMC 108	TSMC 108	
	AMR 312 S coupling						
48A-4	Disc pack	1.132	2	2	2	2	1524-157
48B-4	Bolt	0.054	16	16	16	16	1524-165
48C-4	Bevel washer	0.010	4	4	4	4	1524-187
48D-4	Lock nut	0.018	16	16	16	16	1524-173
48E-4	Washer	0.008	16	16	16	16	1524-181
	Capacity regulation						
50A-1	Valve body with 1 solenoid valve without coil		1				3143-383
50A-2	Valve body with 2 solenoid valves without coils			1		1	3143-384
50A-3	Valve body with 3 solenoid valves without coils				1		3143-385
50A-4	Valve body with 4 solenoid valves without coils					1	3143-386
50B-1	Coil 220/230V, 50/60 Hz, 10 W	0.260					1372-537
50B-2	Coil 110V, 50/60 Hz, 10 W	0.260					1372-538
50B-3	Coil 240V, 50 Hz, 10 W	0.062					1372-539
50C	Solenoid valve (service kit for one solenoid valve)						1372-424
	Crankcase heater						
57A-1	Crankcase heater - 270 W - 115 V, 1 1/4" BSP		1	1	1	1	3181-034
57A-2	Crankcase heater - 270 W - 230 V, 1 1/4" BSP		1	1	1	1	3181-035
57A-3	Crankcase heater - 270 W - 250 V, 1 1/4" BSP		1	1	1	1	3181-036
57B-1	Sealing ring dia. 42/49 x 6,5	0,022	1	1	1	1	1349-213
80	Solenoid valve blok, complete with 0,6 mm orifice for oil return. excl. coil	2.040	1	1	1	1 or 2	1372-179
	Strainer kit consist of:		1	1	1	1 or 2	1372-089
80E	Strainer						
80G	Al-gasket						
	Service kit consist of:		1	1	1	1 or 2	1372-086
80P	Armature tube						
80H	Armature						
80K	O-ring						
80M	O-ring						
80L	Al-gasket						
80N	Snap fastener						
	Seal kit consist of:		1	1	1	1 or 2	1372-091
80G	Al-gasket						
80K	O-ring						

Pos.	Designation	Weight each in kg	Number each compressor				Part no.
			SMC 104	SMC 106	SMC 108	TSMC 108	
80M	O-ring						
80L	Al-gasket						
80Q	Al-gasket						
	Orifice kit 0,6 mm consist of:		1	1	1	1 or 2	1371-034
80L	Al-gasket						
80Q	Al-gasket						
80I	Orifice 0,6 mm						
	Orifice kit 0,8 mm consist of:		1	1	1	1 or 2	1371-035
80L	Al-gasket						
80Q	Al-gasket						
80I	Orifice 0,8 mm						
	Orifice kit 1,0 mm consist of:		1	1	1	1 or 2	1371-036
80L	Al-gasket						
80Q	Al-gasket						
80I	Orifice 1,0 mm						
	Orifice kit 3,3 mm (for thermopump only) consist of:		1	1	1	1 or 2	1371-037
80L	Al-gasket						
80Q	Al-gasket						
80I	Orifice 3,3 mm						
80J-1	Coil 220/230V, 50/60 Hz, 10 W	0.285					1372-537
80J-2	Coil 110 V, 50/60 Hz, 10 W	0.285					1372-538
80J-3	Coil 240 V, 50 Hz, 10 W	0.285					1372-539
80J-4	Coil 24 V, 50 Hz, 10 W	0.285					1372-541
	Intermediate pressure connections						
90A-1	Mixing chamber with flange	9.500				1	3114-095
90B-1	Counter flange for mixing chamber	1.700				1	3115-084
90C-1	Intermediate ring	0.392				1	3422-100
90D-1	O-ring PRP 236 - 82,15 3,53 *)	0.002				1	1331-077
90E-1	O-ring PRP 241 - 98,02 x 3,5 *)	0.002				1	1331-081
90F-1	Hexagon head screw M12 x 65	0.065				4	1424-222
90G-1	Hexagon head screw M14 x 55	0.065				4	1424-246
90H-1	Spring washer dia. 12	0.005				4	1437-026
90J-1	Spring washer dia. 14	0.004				4	1437-030
90K-1	Nut M14	0.025				4	1432-066
90L-1	O-ring PRP 239 - 91,67 x 3,53 *)	0.003				1	1331-080
90M-1	Cap	0.065				1	2313-027
90N-1	Gasket dia. 18/10 x 1,5	0.002				1	2356-123
	Oil cooling - type HE8 S for R22						
92A-1	Oil cooler		1	1	1	1	4242-038
92B-1	Stop valve BMSL 10	0.300	1	1	1	1	1374-171

Pos.	Designation	Weight each in kg	Number each compressor				Part no.
			SMC 104	SMC 106	SMC 108	TSMC 108	
92C-1	Thermostatic expansion valve TX 2 - 0,5	0.400	1	1	1	1	1371-305
92D-1	Solenoid valve without coil	0.346	1	1	1	1	1372-422
92N-1	Coil 220/230V, 50/60 Hz, 10 W	0.260					1372-537
92N-2	Coil 110V, 50/60 Hz, 10 W	0.260					1372-538
92N-3	Coil 240V, 50 Hz, 10 W	0.260					1372-539
92E-1	Filter	0.320	1	1	1	1	4522-002
92F-1	Screwed connection GE 10-LR 1/4"	0.050	6	6	6	6	1349-051
92G-1	Single banjo connector DSVW 10-LR	0.160	1	1	1	1	1349-089
92H-1	Threaded nipple	0.110	1	1	1	1	2314-056
92J-1	Threaded plug for 8/6 mm pipe	0.015	2	2	2	2	2314-053
92K-1	Gasket dia. 19/14 x 1,5 - aluminium	0.001	8	8	8	8	2356-124
92L-1	Connection piece for 1 pipe dia. 8 mm	0.030	2	2	2	2	2333-021
92M-1	Gasket - dia. 27/21 x 1,5 - aluminium	0.001	3	3	3	3	2356-133
	Oil cooling - type OOSI for R717						
93A-1	Oil cooler		1	1	1	1	4242-029
93B-1	Stop valve SN 6		1	1	1	1	2413-010
93C-1	Thermostatic injection TEAT 20-2	0.400	1	1	1	1	1371-240
93D-1	Solenoid valve without coil	0.346	1	1	1	1	1372-422
93N-1	Coil 220/230V, 50/60 Hz, 10 W	0.260					1372-537
93N-2	coil 110V, 50/60 Hz, 10 W	0.260					1372-538
93N-3	Coil 240V, 50 Hz, 10 W	0.260					1372-539
93E-1	Filter	0.320	1	1	1	1	4522-002
93F-1	Screwed connection GE 10-LR 1/4"	0.050	6	6	6	6	1349-051
93G-1	Single banjo connector DSVW 10-LR	0.160	1	1	1	1	1349-089
93H-1	Threaded nipple	0.110	1	1	1	1	2314-056
93J-1	Threaded plug for dia. 8/6 mm pipe	0.015	4	4	4	4	2314-053
93K-1	Gasket dia. 19/14 x 1,5 - aluminium	0.001	8	8	8	8	2356-124
93L-1	Connection piece for 1 pipe dia. 8 mm	0.030	4	4	4	4	2333-021
93M-1	Gasket dia. 27/21 x 1,5 - aluminium	0.001	3	3	3	3	2356-133
	Chain drive for oil pump						
	Chain drive complete						3141-127
96A-1	Hub for chain wheel (chranshaft)		1	1	1	1	2126-020
96B-1	Hub for chain wheel (oil pump)		1	1	1	1	2126-019
96C-1	Chain wheel (crankshaft)		1	1	1	1	2126-018
96D-1	Chain wheel (oil pump)		1	1	1	1	2126-017
96E-1	Chain		1	1	1	1	1521-102
96F-1	Hexagon head screw		5	5	5	5	1424-150
96G-1	Spring washer		5	5	5	5	1437-022
96H-1	Shield for oil		1	1	1	1	3141-128

Pos.	Designation	Weight each in kg	Number each compressor				Part no.
			SMC 104	SMC 106	SMC 108	TSMC 108	
98	Thermo pump						
98A-1	Side cover for thermo pump		1	1	1	1	3113-145
98B-1	Monitor box		1	1	1	1	1553-215
	Allen screw M4 x 16		2	2	2	2	1412-204
	Spring washer dia. 4		2	2	2	2	1437-020
98C-1	Level indicator		2	2	2	2	3185-038
98D-1	Outer part for level indicator		2	2	2	2	3185-034
98E-1	Washer dia. 20/13 x 1,5		2	2	2	2	2356-125
98F-1	Rubber cap		2	2	2	2	1554-194
98G-1	Solenoid valve without coil		1	1	1	1	1372-422
98H-1	Solenoid valve without coil		1	1	1	1	1372-423
98J-1	Coil 220/230V, 50/60 Hz, 10 W	0.285					1372-537
98J-2	Coil 110V, 50/60 Hz, 10 W	0.285					1372-538
98J-3	Coil 240V, 50 Hz, 10 W	0.285					1372-539
98K-1	Check valve		2	2	2	2	1364-008
	Straight joint 10 mm BSP		6	6	8	5	1349-051
	Socket 10 mm BSP		5	5	4	4	1349-101
	T-joint 10 mm		3	4	5	1	1349-041
	Strap for stop valve		1	1	1	1	2212-059
	Cable binder no. 10		1	1	1	1	1554-054
	Allen screw M4 x 12		2	2	2	2	1412-203
	Nut M4		2	2	2	2	1432-035
98L-1	Washer dia. 29/21 x 1,5		2	2	2	2	2356-136
98M-1	VA-joint with nozzle 1,2 mm		3	4	5		2314-097
98M-2	VA-joint with nozzle 0,6 mm					1	2314-100
	Angle joint		3	3	2	1	1349-033
	Angle swivel joint 8 mm		4	4	4		1349-087
	Angle swivel joint 10 mm		3	3	2	1	1349-089
	Angle joint 10 mm				1		1349-112
	Bushing 1/4" x 1/2" RG		2	1	1		2312-013
	Threaded nipple		1	1			2314-056
	Gasket dia. 27/21 x 1,5 Al		2	2	2		2356-133
	Gasket dia. 19/14 x 4 Al		3	3	3	1	2356-283
	Pipe strap dia. 10 x 15		2			1	1377-117
	Hexagon set screw M6 x 12		1				1424-150
	Nut M6		1				1432-061
	Allen screw M5 x 10					1	1413-330
	Washer dia. 12,5/6,4 x 1,6		2				1436-033
	Spring washer for M6					1	1437-021
98N-1	Filter		1	1	1	1	4522-002
98P-1	Stop valve		1	1	1	1	2412-277

Pos.	Designation	Weight each in kg	Number each compressor				Part no.
			SMC 104	SMC 106	SMC 108	TSMC 108	
98Q-1	Cooling cover		1	1	1	1	3113-143
98R-1	Gasket for side cover		1	1	1	1	2353-151
98S-1	Hexagon head screw M14 x 80		16	16	16	16	1424-081
98T-1	Oil cooler OSSI		1	1	1	1	4242-029
	Socket 1/4"		1	1	1	1	1349-101
98U	Solenoid valve without coil		1	1	1		1372-422
98V	Solenoid valve without coil		1	1	1	1	1372-422
98AB-1	Coil 220/230V, 50/60 Hz, 10 W	0.285					1372-537
98AB-2	Coil 110V, 50/60 Hz, 10 W	0.285					1372-538
98AB-3	Coil 240V, 50 Hz, 10 W	0.285					1372-539
98X	PT100 sensor		1	1	1	1	1373-253
98Y	Stop valve		1	1	1	1	2412-277
98Z	Non-return valve		1	1	1	1	1364-022
98AA	Screw joint		1	1	1	1	2314-105
	UNISAB						
99A-1	Support for UNISAB		1	1	1	1	2213-500
99B-3	Distance washers		4	4	4	4	2212-130
99C-1	Screw for support M10 x 20		2	2	2	2	1424-190
99D-1	Screw for UNISAB M6 x 20		4	4	4	4	1424-152
99E-1	Washers dia. 22/7 x 1,5		4	4	4	4	1436-025

Spare parts set for compressor SMC 104-106-108 & TSMC 108 Mk 3 Type S-L-E

Line no. A501 = Normal Set

Line no. A502 = Extended Set

Line no. A503 = Certificate Set

Line no. A504 = Special Set

Pos. No.	Designation	Part No.	Spare parts set line no.			
			A501	A502	A503	A504
1B - 1	Oil level glass dia. 80	1226-015			1	
1C - 1	O-ring - dia. 52,07x2,62 no. 137	1331-140			2	2
2C - 1	gasket for top cover	2353-151	2	4	4	6
2F - 1	hexagon-head screw M14x120 8,8 DIN 931	1424-090			2	
3H - 1	hexagon-head screw M12x 40 8,8 DIN 933	1424-217			2	
4B - 1	gasket for end cover at oil pump	2353-011	1	1	1	2
4C - 1	hexagon-head screw M14x100 8,8 DIN 931	1424-085			2	
5B - 1	hexagon-head screw M14x 35 8,8 DIN 933	1424-240			2	
5C - 1	bearing bushing	2132-021				2
6B - 1	hexagon-head screw M13x 60 8,8 DIN 933	1424-245			2	
8B - 1	gasket for cover for shaft seal	2353-005	1	1	1	2
8C - 1	hexagon-head screw M10x 35 8,8 DIN 933	1424-193			4	
10 - 1	shaft seal (spare parts set)	3126-178	1	1	4	2
11P - 1	gasket - dia. 32/27x1,5 mm	2356-139		2	2	2
12K - 1	Benzing-ring - dia. 9 mm	1437-105				4
12K - 2	Benzing-ring - dia. 7 mm	1437-103		4	4	4
12S - 1	gasket for unloading cylinder 100x100x2	2354-023			4	4
13E - 1	countersunk screw M 6x16	1413-092			2	
15D - 1	spring for unloading mechanism	2142-061		2	4	8
17 - 1	connecting rod complete	3123-004			1	
17A - 1	half-section of bearing	2133-003			4	16
17B - 1	bushing for piston pin	2132-004				4
18 - 1	piston with pin and rings			1	1	2

Pos. No.	Designation	Part No.	Spare parts set line no.			
			A501	A502	A503	A504
18A - 1	piston pin	3125-084				4
18B - 1	piston ring	3125-130	4	4	4	12
18C - 1	oil scraper rings	3125-065	2	2	2	6
19 - 1	cylinder liner with suction valve			1	1	2
19F - 1	ring plate for suction valve	3131-021	4	8	8	8
19G - 1	valve spring	2141-047	30	60	60	90
19K - 1	gasket for cylinder liner - 0,5 mm	2356-111	2	4	8	8
19K - 2	gasket for cylinder liner - 0,8 mm	2356-233	2	4	4	8
19N - 1	socket cap screw M 6x30 8,8 DIN 912	1413-343			6	
20 - 1	discharge valve			1	1	2
20C - 1	ring plates for discharge valve	3131-015	4	8	8	8
20D - 1	countersunk screw M12x60	1413-121			2	
20E - 1	nut M12x1,25	1432-075			2	
22G - 1	gasket for oil pressure valve	2354-075		1	1	2
22H - 1	hexagon-head screw M12x35 8,8 DIN 933	1424-216			2	
24A - 1	spring for safety valve (SMC TSMC LP)				2	1
24G - 1	hexagon-head screw M 8x25 8,8 DIN 933	1424-168			2	
25H - 1	sealing ring (only for SMC dia. 62/45x3)	2354-003		1	1	2
25H - 4	sealing ring 110/91x3	2354-117		1	1	2
25J - 1	O-ring dia. 72.39x5.33	1331-154		1	1	2
25J - 4	O-ring dia. 116.84x7.0	1331-198		1	1	1
25K - 1	spindle for discharge stop valve	2442-023			1	
25K - 4	spindle for suction stop valve	2442-028			1	
25P - 1	O-ring dia. 21.8x3.53 No.212	1331-020		4	8	8
25P - 4	O-ring dia. 28.1x3.6 No.216	1331-024		1	2	2
25R - 1	O-ring dia. 17.12x2.6	1331-016		2	4	4
25Z - 1	hexagon-head screw M14x45 8,8 DIN 933	1424-242			2	
25Z - 4	hexagon-head screw M16x45 8,8 DIN 931	1424-102			2	

Pos. No.	Designation	Part No.	Spare parts set line no.			
			A501	A502	A503	A504
25AG-3	gasket for stop valve	2354-105	1	2	2	2
25AG-4	gasket for stop valve	2354-106	1	2	2	2
30 - 1	suction and oil pressure gauge				1	1
31 - 1	discharge pressure gauge				1	1
33A - 1	filter cartridge	1517-129	1	1	2	1
33B - 1	gasket	2356-202	1	1	2	1
34B - 1	filter bag	3425-083		2	4	2
34D - 1	O-ring dia. 75.56x5.33	1331-042	2	2	2	2
34F - 1	O-ring dia. 91.67x3.53 No. 239	1331-080	2	2	2	2
38E - 1	O-ring dia. 29.51x5.33 No. 321	1331-039		1	2	2
38F - 1	gasket dia.27/21x1.5 mm	2356-133		2	2	2
38P - 1	O-ring dia. 26.58x3.55	1331-023		1	2	2
50 - 1	coil for solenoid valve				1	1
	for TSMC compressor further:					
2D	gasket for water cover (TSMC)	2353-176	1	2	2	2(1)
17 - 2	connecting rod complete (TSMC HP)	3123-006			1	
17B - 2	needle roller bearing (TSMC HP)	1511-275				2
19M - 1	O-ring for cylinder liner	1331-085	2	2	4	4
24A - 2	spring for safety valve (TSMC HP)				2	1
25H - 1	sealing ring 62/45x3	2354-003		1	3	2
90D - 1	O-ring dia. 82.15X3.5	1331-077	1	1	1	1
90E - 1	O-ring dia. 98.02X3.5	1331-081	1	1	1	1
	for water cooled compressors, further:					
2D	gasket for water cover, R/L	2353-175	1	2	2	2(3)
2D	gasket for water cover, top-side	2353-154	1	1	1	2
2E - 2	hexagon-head screw M14x110 8.8 DIN 931	1424-087			16	
3E - 2	hexagon-head screw M14x 55 8.8 DIN 933	1424-244			6	
3F - 12	hexagon-head screw M14x 35 8.8 DIN 933	1424-240			2	

Pos. No.	Designation	Part No.	Spare parts set line no.			
			A501	A502	A503	A504
	for air cooled compressors, further:					
2E - 1	hexagon-head screw M14x90 8.8 DIN 931	1424-083			16	
3E - 1	hexagon-head screw M14x65 8.8 DIN 931	1424-246			6	
	for belt-driven compressors, further:					
	V-belts				1 set	1 set
	for direct driven compressors, further:					
	AMR coupling set	1524-152			1 set	1 set

The No. depends on the compressor to which the spare parts set belongs.

**Spare parts survey
for
thermo-pump SMC 104-106-108 & TSMC 108**

Pos. no.	Designation	Weight in kg.	SMC 104	SMC 106	SMC 108	TSMC 108	Part no.
98A	side cover for thermo-pump	13.800	1	1	1	1	3113-145
98B	monitor box	0.960	1	1	1	1	1553-031
98C	level indicator complete	0.100	2	2	2	2	3185-038
98D	outlet part of level indicator	0.520	2	2	2	2	3185-034
98E	gasket dia. 20/13x1,5	0.001	2	2	2	2	2356-125
98F	rubber cap	0.007	2	2	2	2	1554-194
98G	solenoid valve whitout coil		1	1	1	1	1372-453
98H	solenoid valve whitout coil		1	1	1	1	1372-358
98J-1	coil 14W, 115V, 60Hz	0.130	2	2	2	3	1372-055
98J-2	coil 14W, 220V, 50Hz	0.130	2	2	2	3	1372-056
98J-3	coil 14W, 240V, 50Hz	0.130	2	2	2	3	1372-319
98J-4	coil 14W, 220V, 60Hz	0.130	2	2	2	3	1372-059
98K	non-return valve 0.2 bar		2	2	2	2	1364-008
98L	solenoid valve whitout coil		1	1	1		1372-453
98M	nozzle		3	4	5	1	2314-097
98N	filter		1	1	1	1	4522-002
98P	stop valve	0.600	1	1	1	1	2413-118
98Q	intermediate cover	12.500	1	1	1	1	3113-143
98T	oil cooler OOSI		1	1	1		4242-029
98U	O-ring for oil cooler dia. 21.8x3.53		1	1	1		1331-020
98V	nylon ring for level indicator	0.003	2	2	2	2	2353-152
98X	O-ring for level indicator dia. 9,2x2.62	0.001	12	12	12	12	1331-011
98Y	gasket for side cover		2	2	2	2	2353-151
98Z	hexagon-head screw M14x80	0.080	16	16	16	16	1424-081
98AC	gasket dia. 19/14x1.5	0.001	4	6	8		2356-125
98AE	gasket dia. 27/21x1.5	0.001	2	2	2	2	2356-136

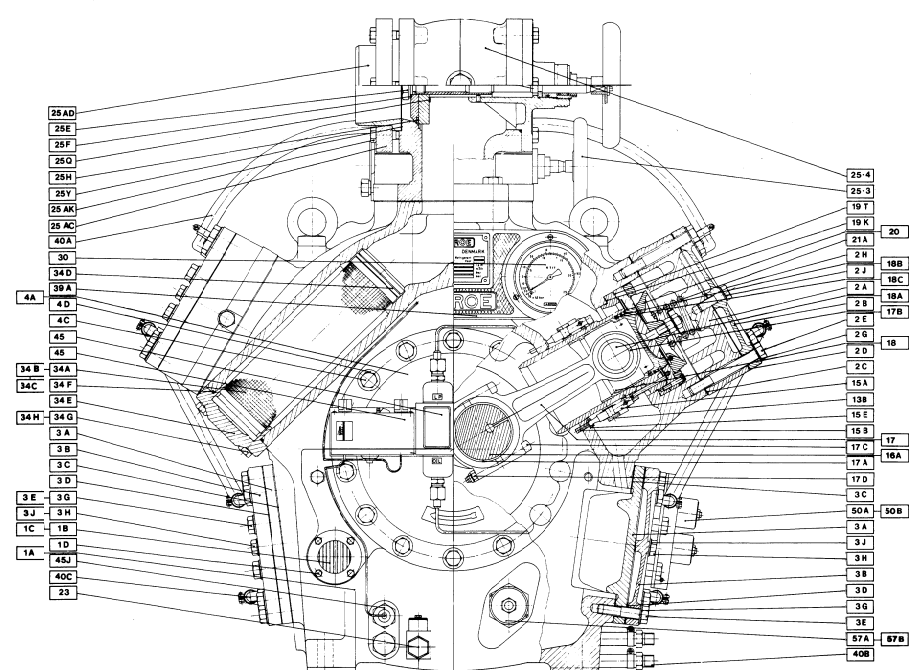
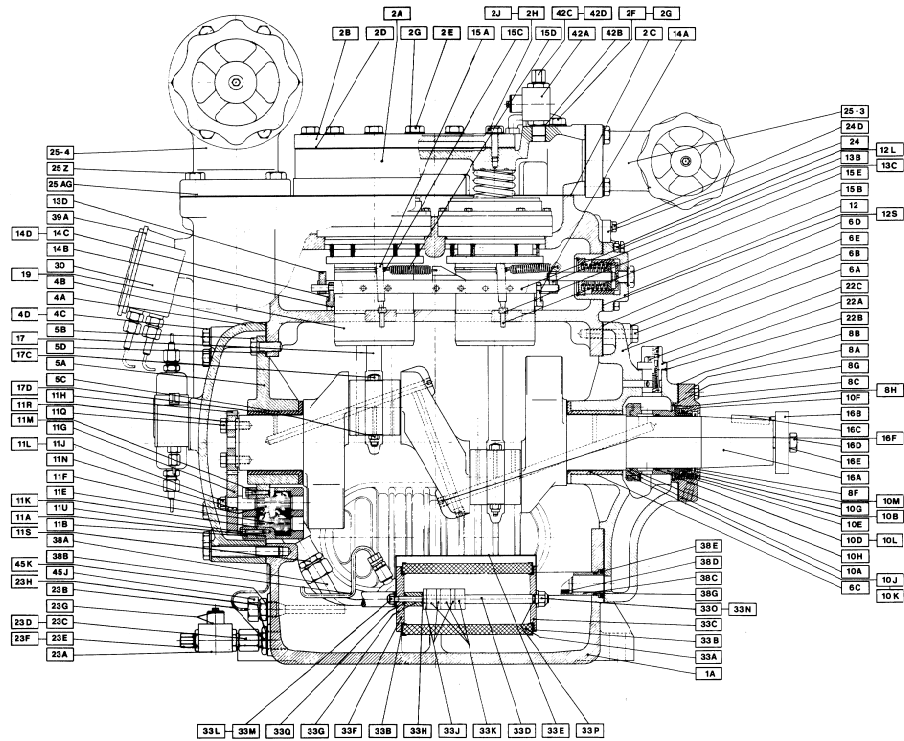

SMC 104-106-108 Mk. 3

List of parts 0661-680

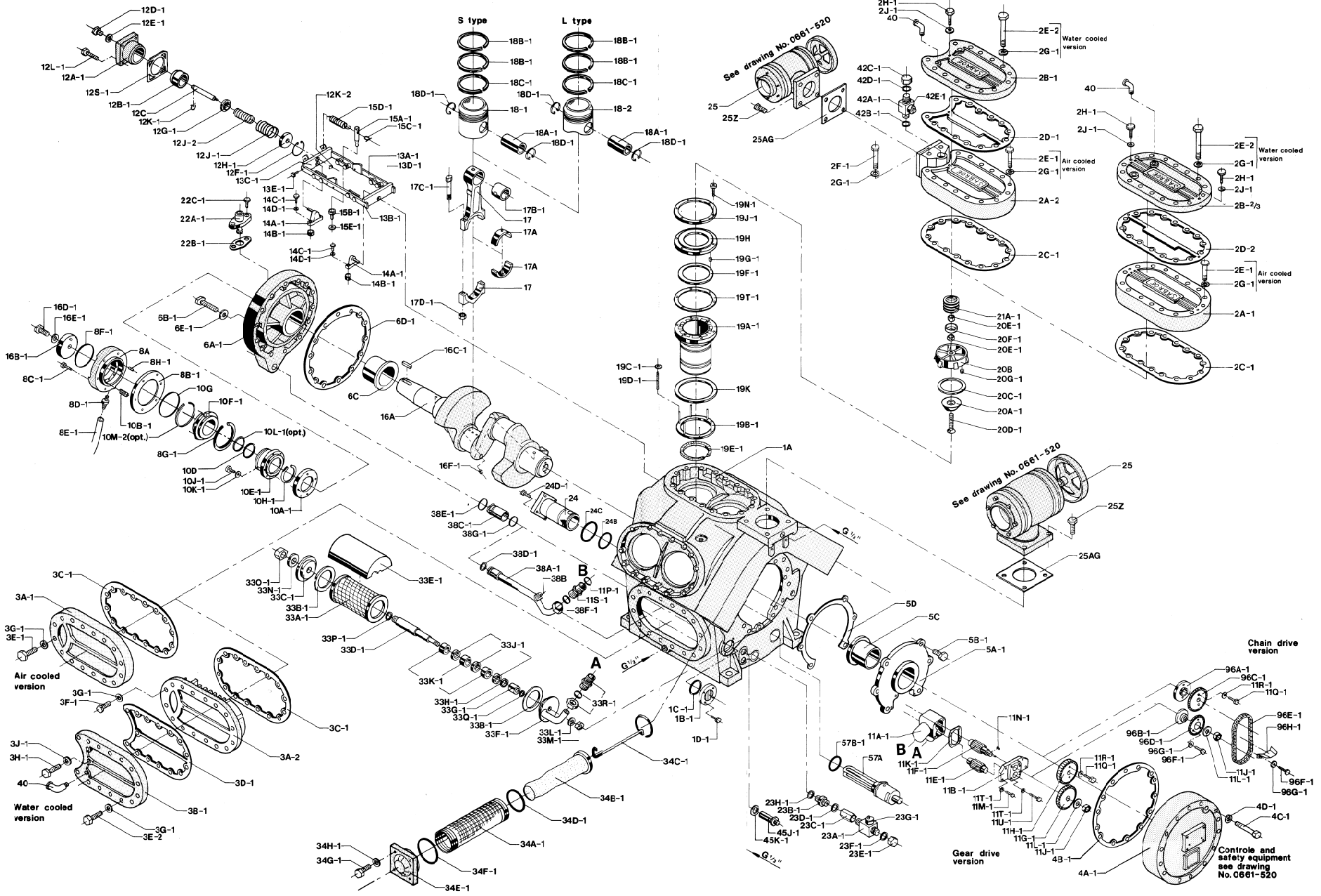

SMC 104-106-108 Mk. 3

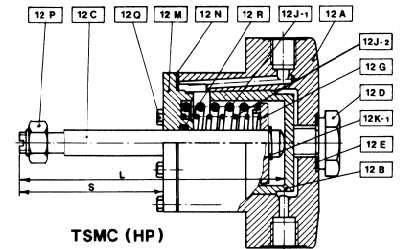
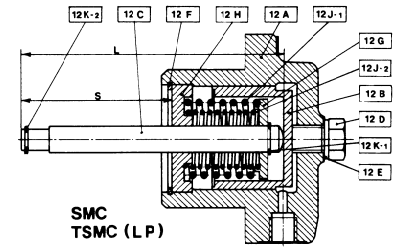
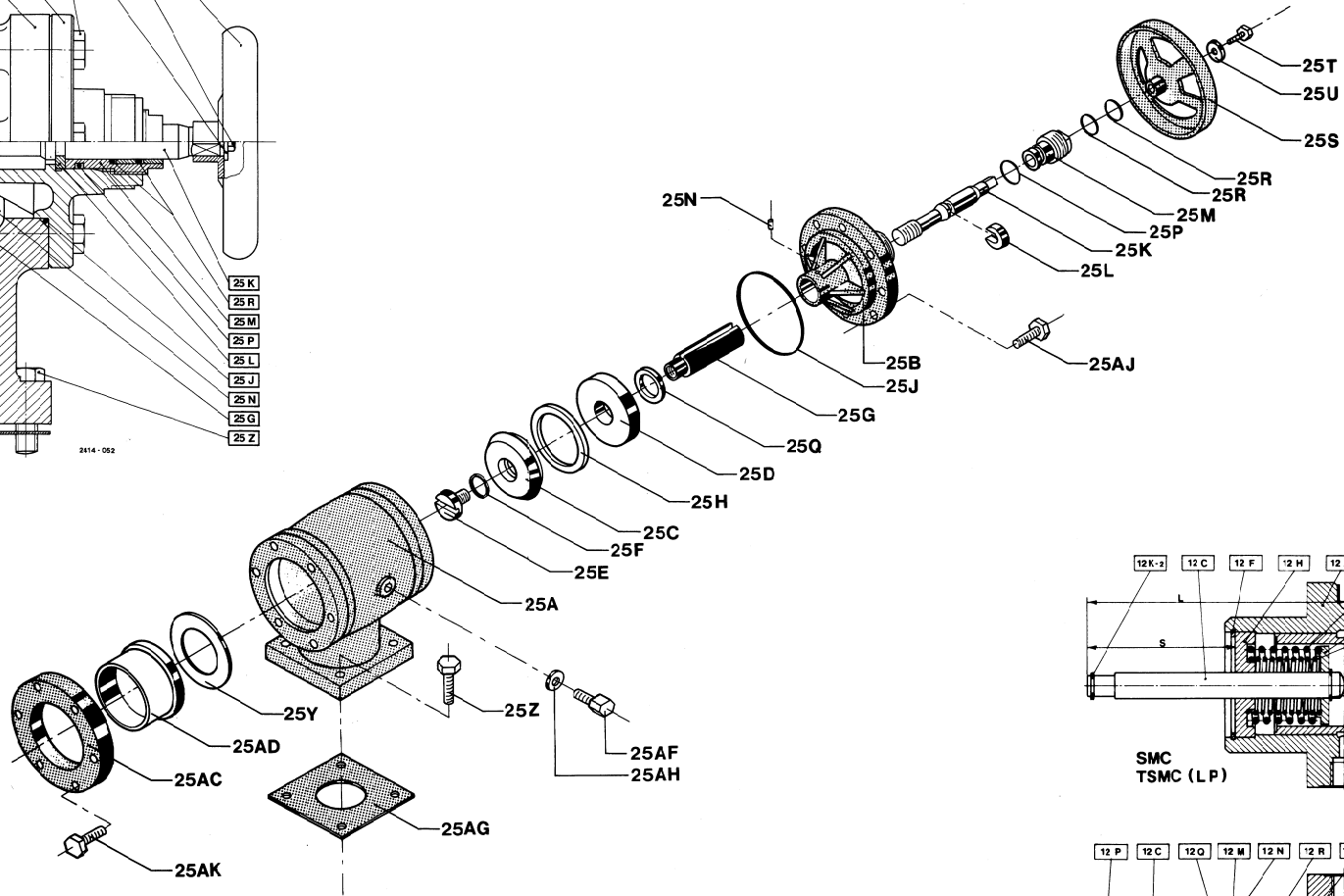
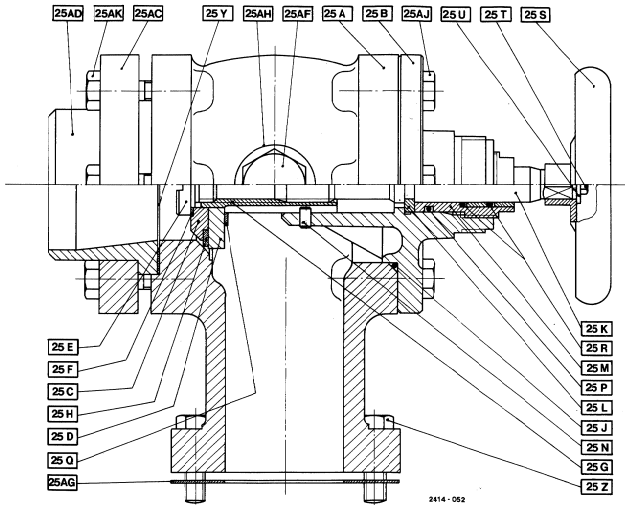

SMC 104-106-108 Mk. 3
TSMC 108 Mk. 3

List of parts 0661-680

UNLOADING CYLINDERS

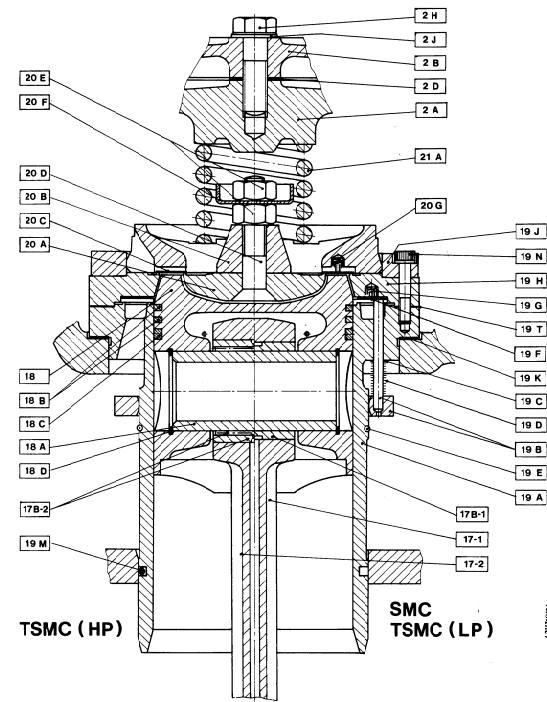
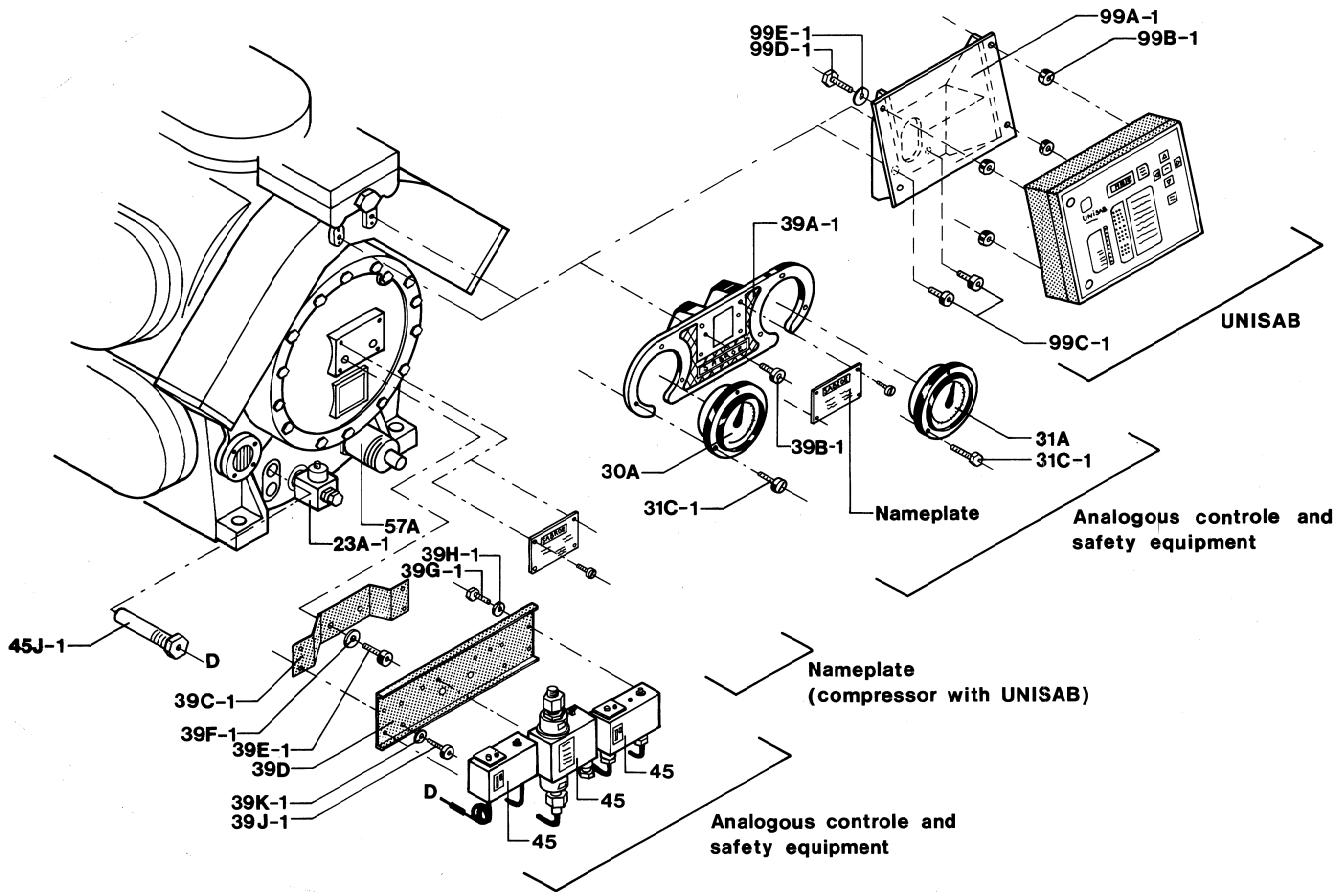

CYLINDERLINER

CONTROL AND SAFETY EQUIPMENT

**SMC 104-106-108 Mk. 3
TSMC 108 Mk. 3**

Tools for compressor

SMC 104-116 Mk3 & TSMC 108-116 Mk3 - Type S-L-E

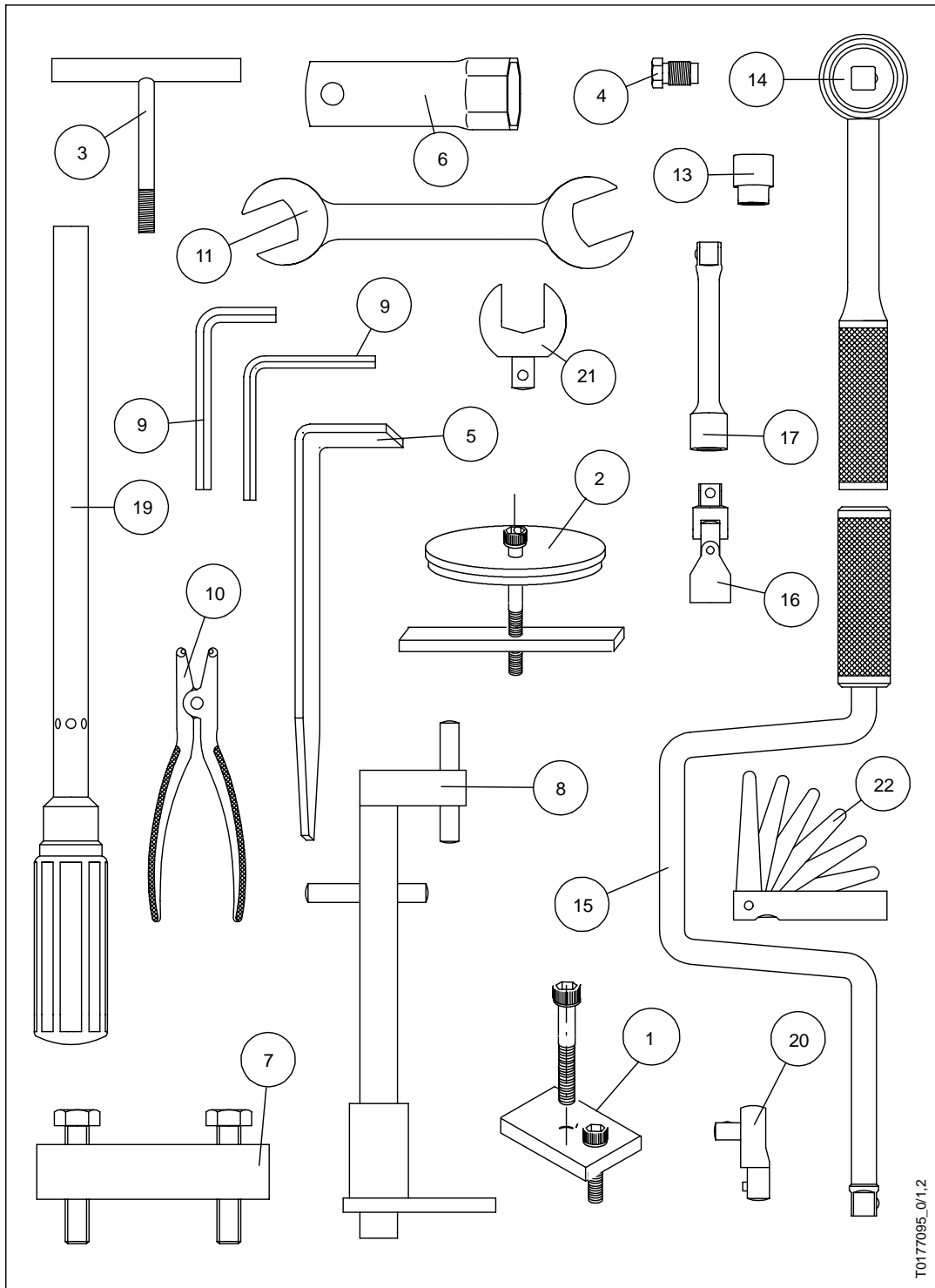

T0177095_0/1,2

Tools set for compressor

SMC 104-116 Mk3 & TSMC 108-116 Mk3 - type S-L-E

Line no. A600 = Normal set, tools set no 3183-109

Line no. A601 = Extended set, tools set no 3183-110

Line no. A602A = Tools for coupling (SMC 104-108)

Line no. A602B = Tools for coupling (SMC 112-116)

Line no. A603 = Tools for alignment of coupling

Pos. No.	Designation	Dimension	Part No.	Line No.			
				A600	A601	A602 A B	A603
1-1	Clamp with screw, compr. type S and L		3183-144	4	4		
1-2	Clamp with screw, compr. type E		3183-145	4	4		
2	Tools for shaft seal		3183-139	1	1		
3	Tommy screw for cylinder liner		3183-041	2	2		
4	Theaded plug for unloading cylinder	3/8" BSP	2314-017	2	2		
5	Supporting plate for pistons		3183-115	8	8		
6	Spanner for heating cartridge	NV 55	3183-060	1	1		
7	Trigger for coupling or belt pulley		3183-059	1	1		
8	Adjusting jig for coupling		3183-105				1
9-1	Wrench for cylinder screw	NV 4			1		
9-2	Wrench for cylinder screw	NV 5			1		
9-3	Wrench for cylinder screw	NV 8			1		
9-4	Wrench for cylinder screw	NV 10			1		
9-5	Special wrench for shaft seal	NV 4	1612-392	1	1		
10-1	Retaining-ring plier	J 21/G			1		
10-2	Retaining-ring plier	A 11/G			1		
11-1	Open end and ring spanner	NV 10			1		
11-2	Open end and ring spanner	NV 17			1		
11-3	Open end and ring spanner	NV 19			1		
11-4	Open end and ring spanner	NV 22			1		
11-5	Open end and ring spanner	NV 24			1		
11-6	Open end and ring spanner	NV 27			1		

Pos. No.	Designation	Dimension	Part No.	Line No.				
				A600	A601	A602 A	A602 B	A603
13-1	Socket wrench	NV 10			1			
13-2	Socket wrench	NV 13			1			
13-3	Socket wrench	NV 17			1			
13-4	Socket wrench	NV 19			1			
13-5	Socket wrench	NV 22			1			
13-6	Socket wrench	NV 24			1	1	1	
13-7	Socket wrench	NV 27			1			
13-8	Socket wrench	NV 30			1			
13-9	Socket wrench	NV 32			1			
13-10	Socket wrench	NV 9/16"			1			
13-11	Socket wrench	NV 3/4"			1		1	
13-12	Socket wrench	NV 11/16"			1	1		
14	Ratchet handle				1			
15	Speed handle				1			
16	Universal joint for socket wrench				1			
17-1	Extension rod for socket wrench				1			
17-2	Extension rod for socket wrench				1			
19-1	Torque wrench 15-90 Nm				1			
19-2	Torque wrench 40-200 Nm				1	1	1	
20	Coupler for torque wrench 1/2				2	1	1	
21-1	Open spanner for torque wrench	NV 11/16"			1	1		
21-2	Open spanner for torque wrench	NV 3/4"			1		1	
22	Feeler gauge							1